

VERTICAL JOINTS
VERTIKALVERBINDER
JONCTIONS VERTICALES
UNIONES VERTICALES

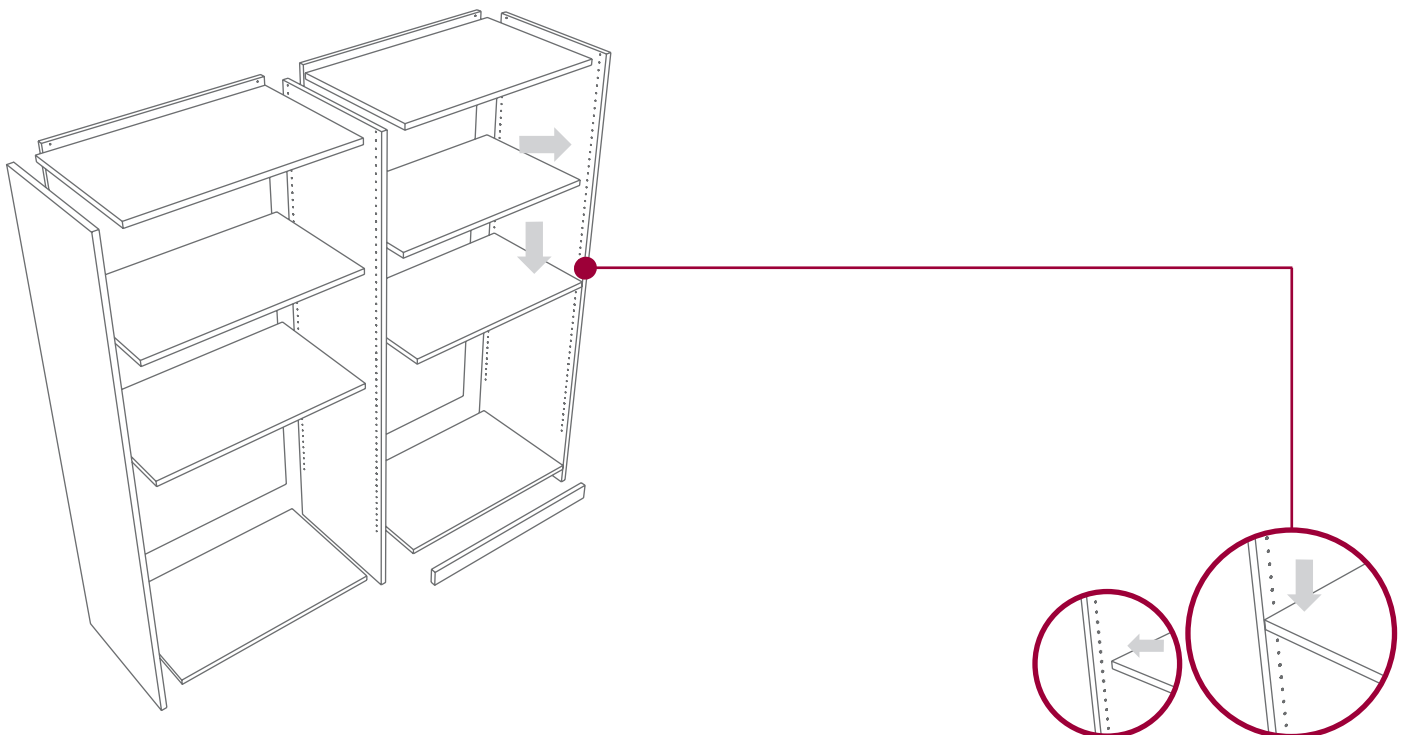

BETA	3 - 8
GAMMA	9 - 14
COMBI	15 - 24
MINICOMBI	25 - 30

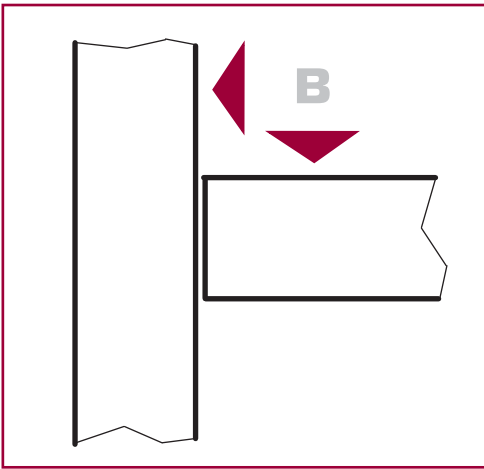

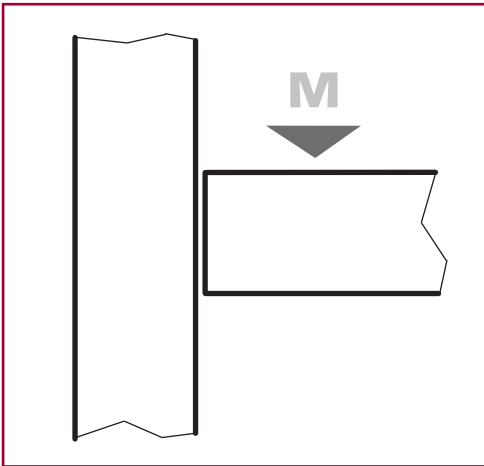

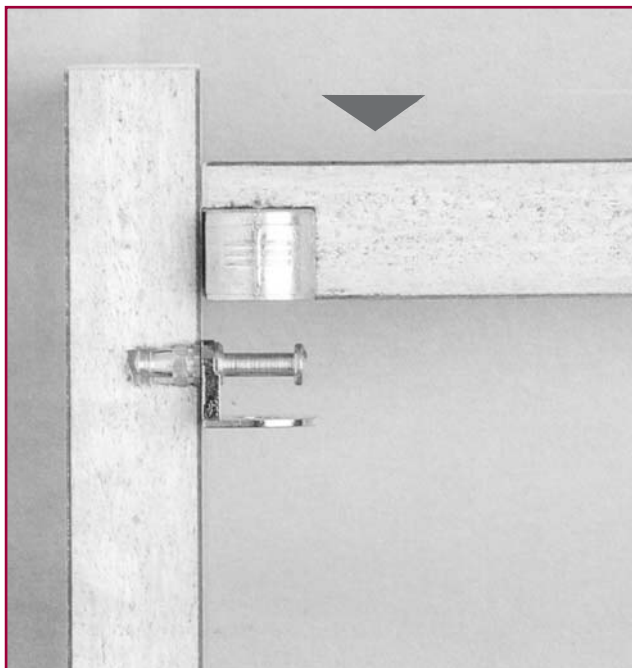

Giunti per l'assemblaggio tangente

Joint for tangent assembling

Korpusverbinder zur vertikalen Montage

Assemblage tangent

Uniones para montaje vertical

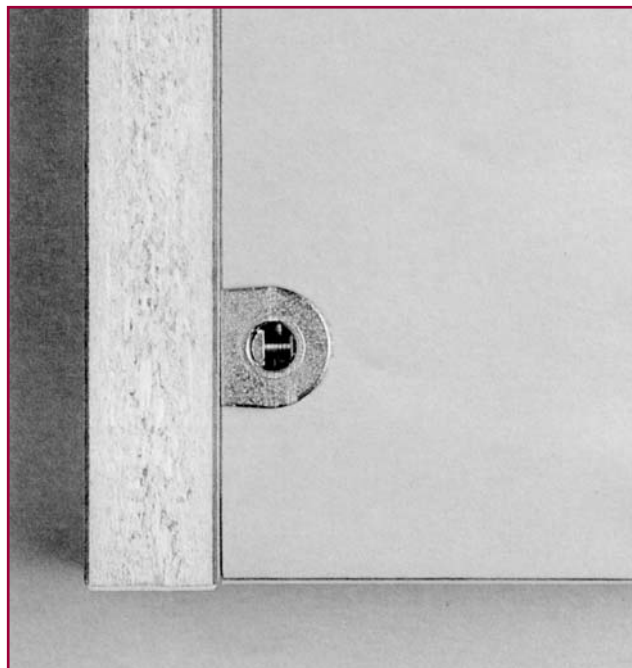

Giunti per l'assemblaggio per accostamento

Joint for side-by-side assembling

Korpusverbinder zur horizontalen Montage

Assemblage par rapprochement

Uniones para montaje horizontal

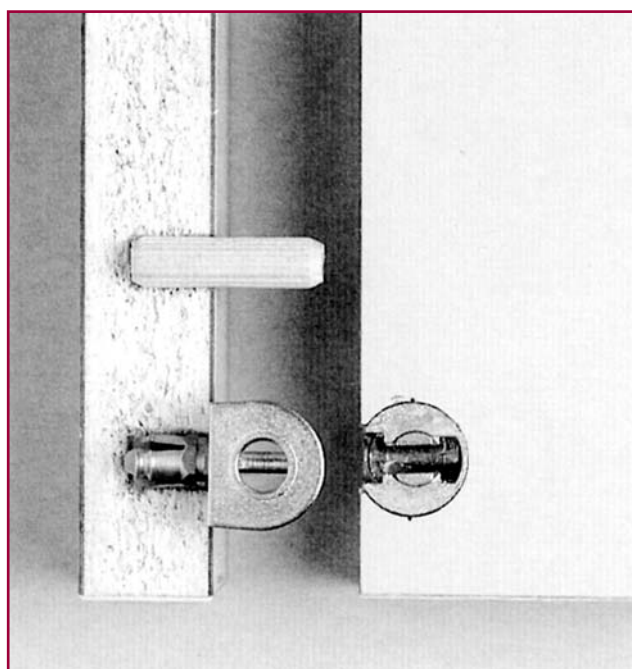
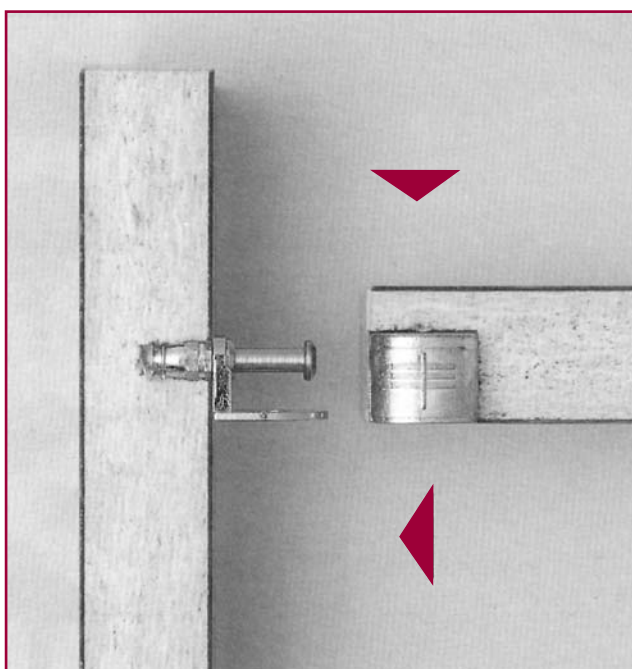



Senza bordo, di metallo
Metall,without collar
Metall,ohne Rand
Sans bord,en métal
Sin borde,metalico

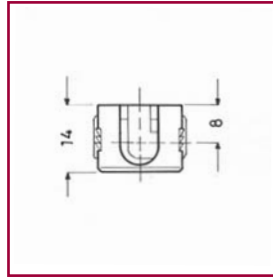

BEMXX0800 BEBXX0800

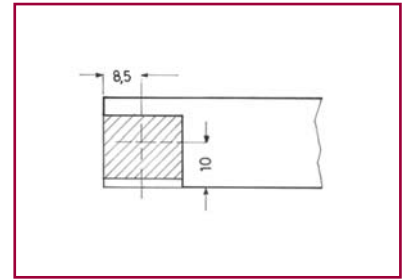
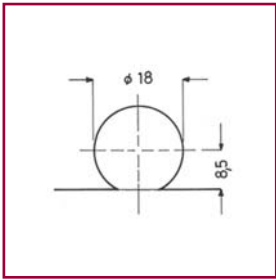
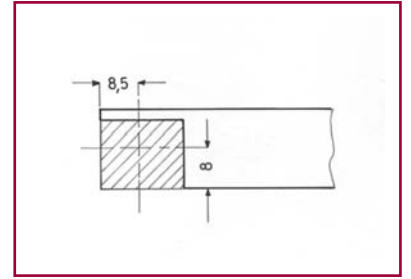

Esecuzioni disponibili **zincato**
Available finishings zinc.-pl.
Oberfläche verzinkt **31**
Finitions disponibles zingué
Colores cincado

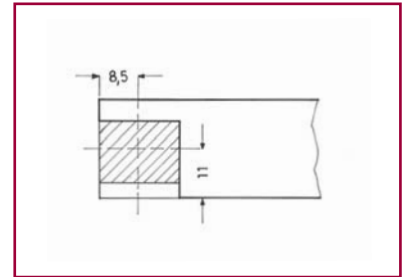

Senza bordo, di metallo
Metall,without collar
Metall,ohne Rand
Sans bord,en métal
Sin borde,metalico

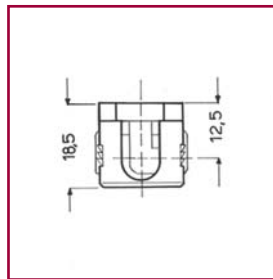

BEMXX1250 BEBXX1250

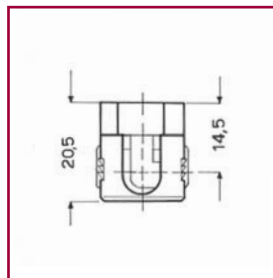
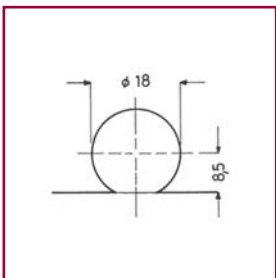
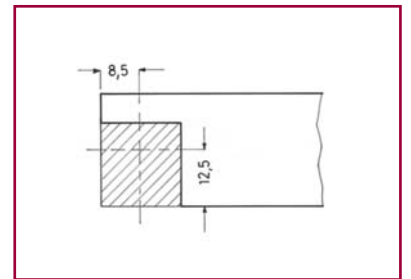

BEMXX1450 BEBXX1450

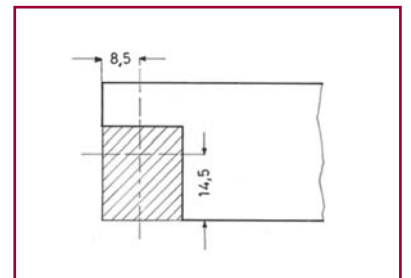

Chiave
Pin
Winkelschlüssel
Clé
Llave

UTXCHBETA33



Supporto di metallo con perno filetto M4

Metallic holder with bolt with M4 thread

Bodenträger mit Gewindebolzen M4

Taquet métallique avec tige filetée M4

Soporte metalico con pernio M4

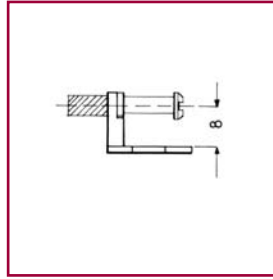
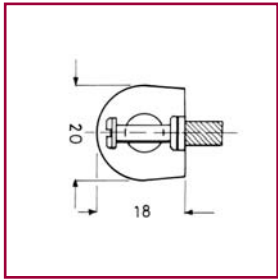

BE080M409

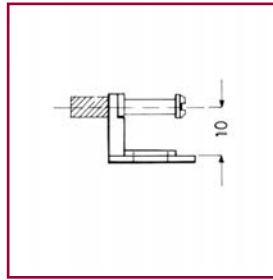
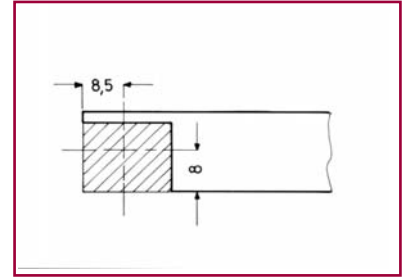

BE100M409

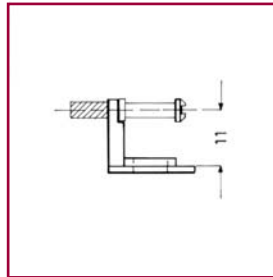
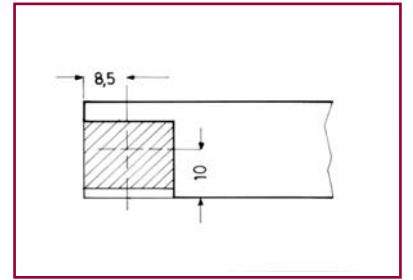

BE110M409

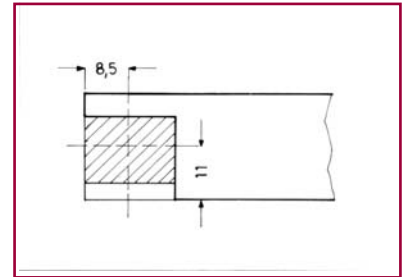

Esecuzioni disponibili

Available finishings

Oberfläche

Finitions disponibles

Colores

nichelato

nickel-pl.

vernickelt

nickelé

niquel

nero

black

36 schwarz

noir

negro

32

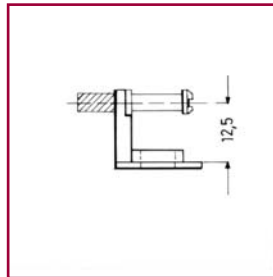

BE125M409

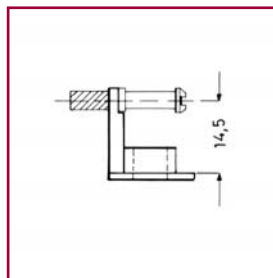
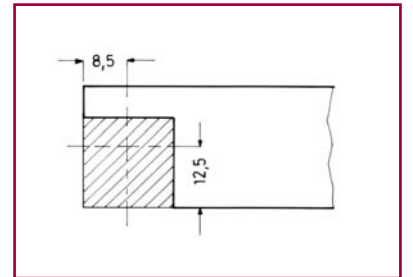

BE145M409

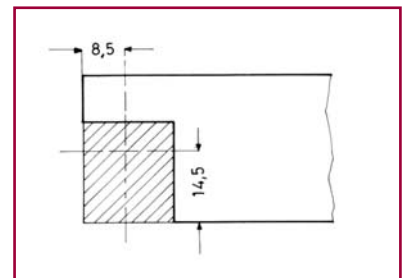

Bussola senza pastiglia

Bush without pellet

Muffe ohne Nylonzylinder

Insert sans pastille

Tuerca sin bola

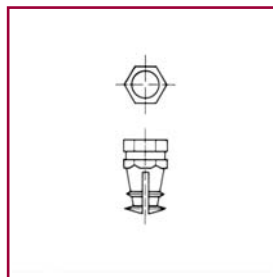

M4X10

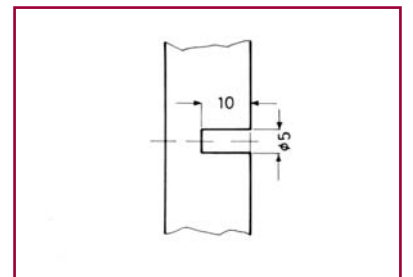

BUXX0410030



Supporto di metallo con perno filetto M6x6

Metallic holder with bolt with M6x6 thread

Bodenträger mit Gewindebolzen M6x6

Taquet métallique avec tige filetée M6x6

Soporte metalico con pernio M6x6

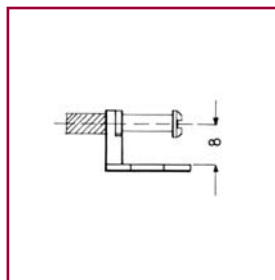
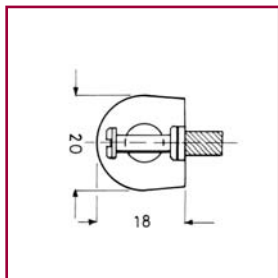

BE080M606

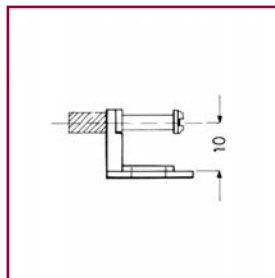
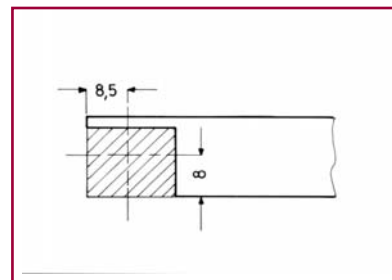

BE100M606

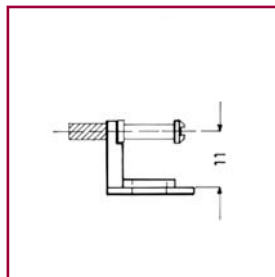
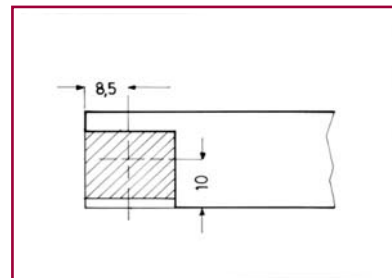

BE110M606

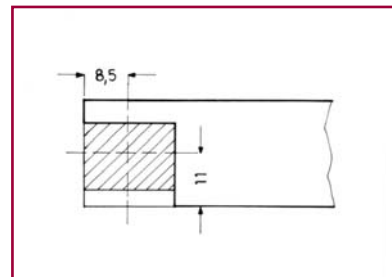

Esecuzioni disponibili

Available finishings

Oberfläche

Finitions disponibles

Colores

nichelato

nickel-pl.

vernickelt **36**

nickelé

niquel

nero

black

schwarz **32**

noir

negro



Bussola con pastiglia

Bush with pellet

Muffe mit Nylonzylinder

Insert avec pastille

Tuerca con bola

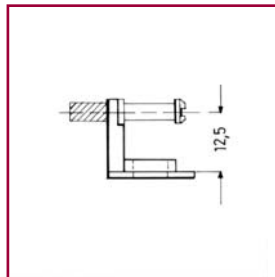

BE125M606

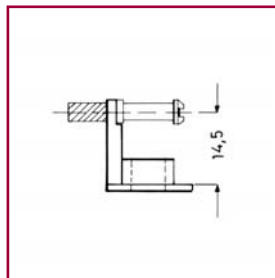
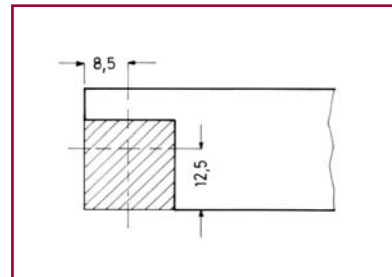

BE145M606

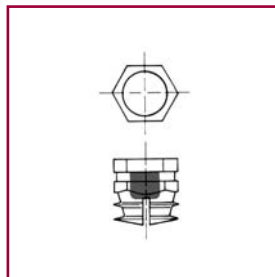
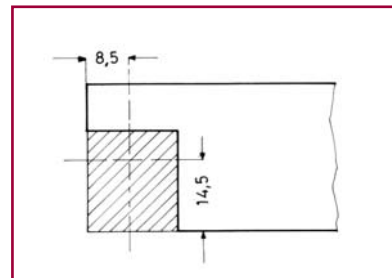

M6

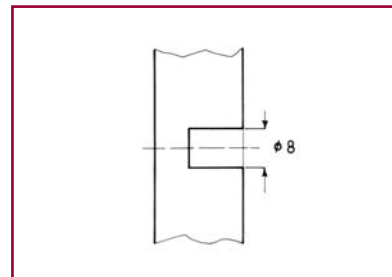

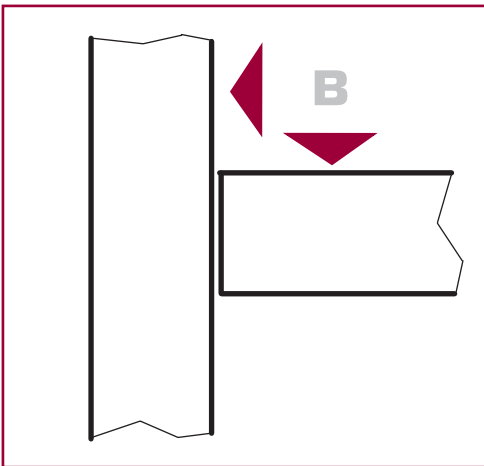
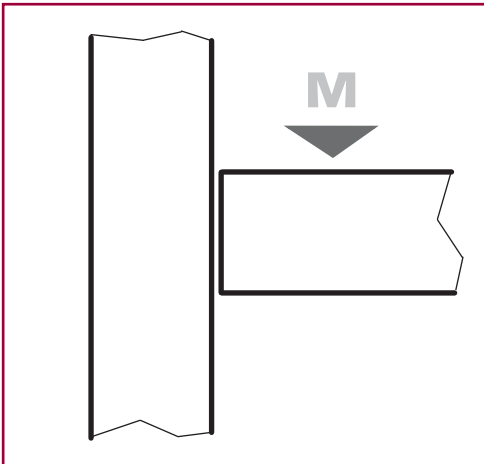

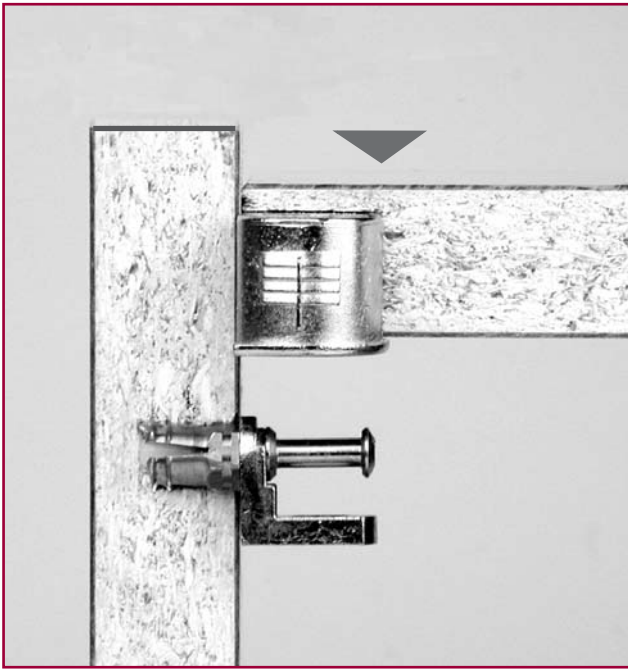

Giunti per l'assemblaggio tangente

Joint for tangent assembling
Korpusverbinder zur vertikalen Montage
Assemblage tangente
Uniones para montajes tangentes

Giunti per l'assemblaggio per accostamento

Joint for side-by-side assembling
Korpusverbinder zur horizontalen Montage
Assemblage par rapprochement
Uniones para montaje horizontal

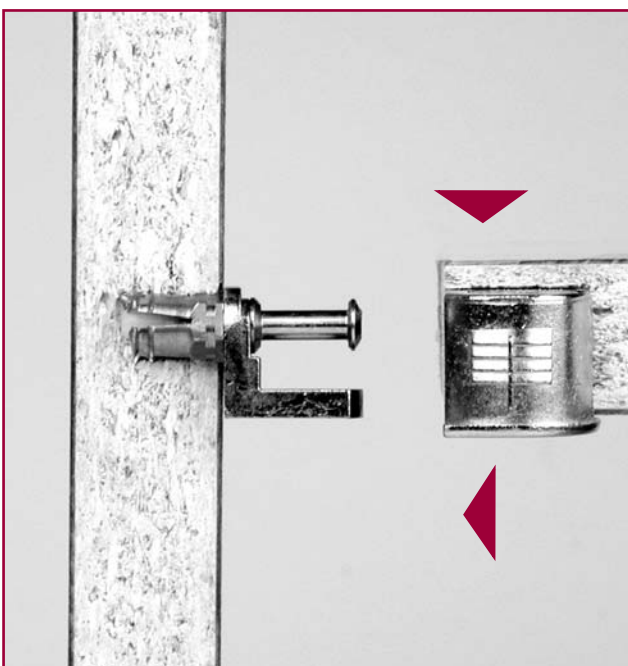



Con bordo, di metallo
Metall,with collar
Metall,mit Rand
Avec bord,en metal
Con borde,metalico

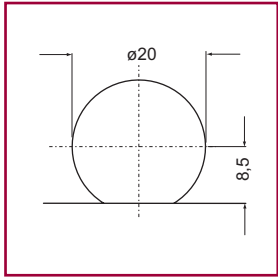

Esecuzioni disponibili

Available finishings
Oberfläche
Finitions disponibles
Colores

nichelato

nickel-pl.
vernickelt
nickelé
niquel

36

nero

black
schwarz
noir
negro

32

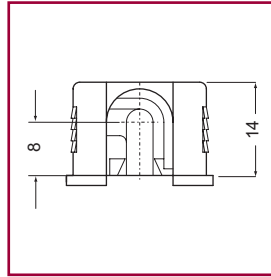

GAMXX0800 **GABXX0800**

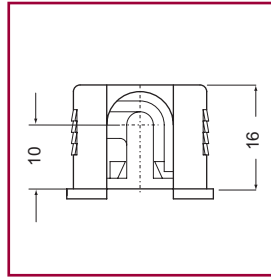
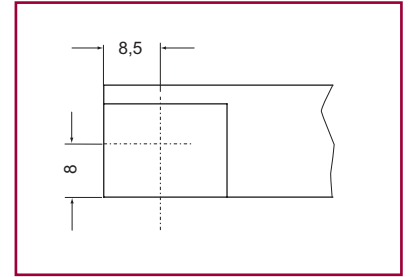

GAMXX1000 **GABXX1000**

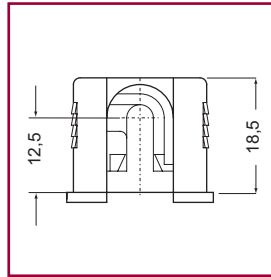
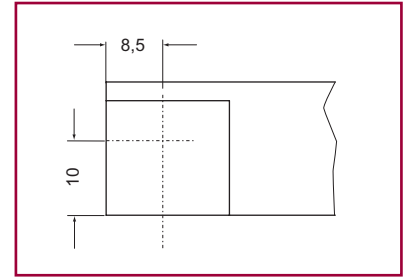

GAMXX1250 **GABXX1250**

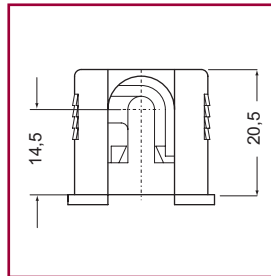
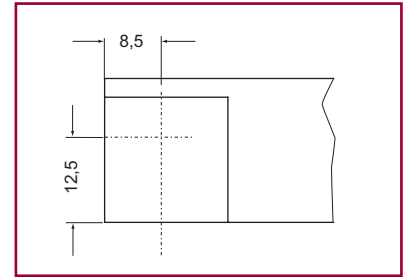

GAMXX1450 **GABXX1450**

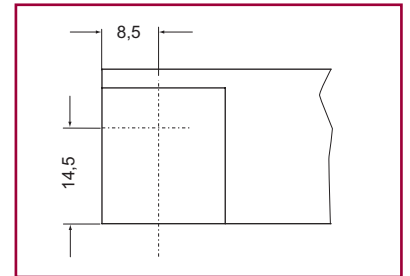

Chiave
Pin
Winkelschlüssel
Clé
Llave

UTXCHBETA33



Supporto di metallo con perno filetto M4

Metallic holder with bolt with M4 thread

Bodenträger mit Gewindebolzen M4

Taquet métallique avec tige filetée M4

Soporte metalico con pernio M4

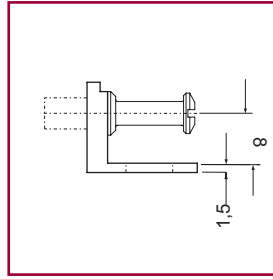
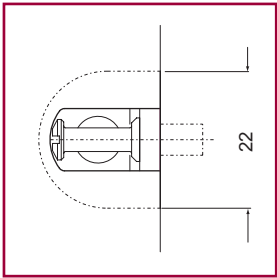

GA080M409

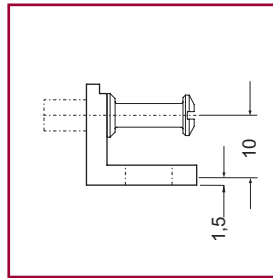
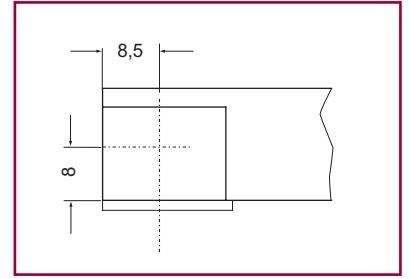

GA100M409

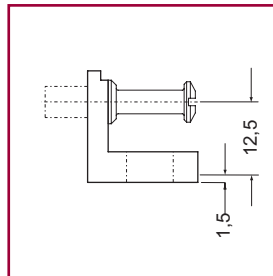
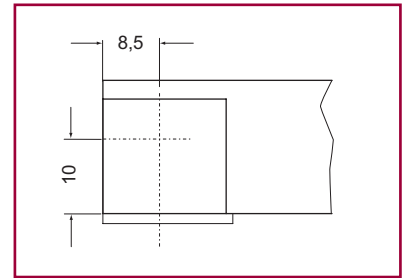

GA125M409

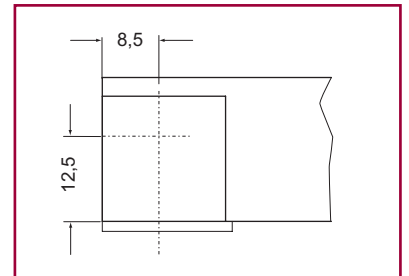

Esecuzioni disponibili

Available finishings

Oberfläche

Finitions disponibles

Colores

nichelato

nickel-pl.

vernickelt

nickelé

niquel

nero

black

schwarz

noir

negro

36

32

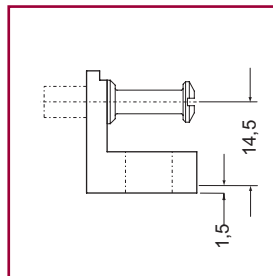

GA145M409

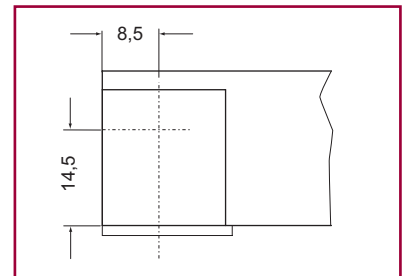

Bussola senza pastiglia

Bush without pellet

Muffe ohne Nylonzylinder

Insert sans pastille

Tuerca sin bola

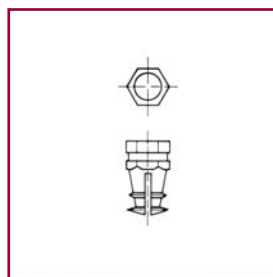

M4X10

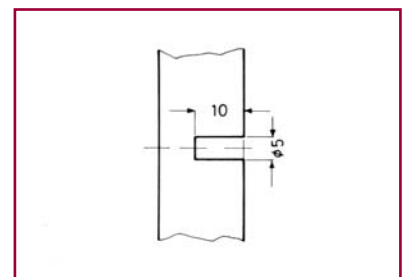

BUXX0410030



Supporto di metallo con perno filetto M6

Metallic holder with bolt with M6 thread

Bodenträger mit Gewindebolzen M6

Taquet métallique avec tige filetée M6

Soporte metalico con pernio M6

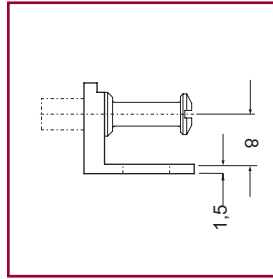
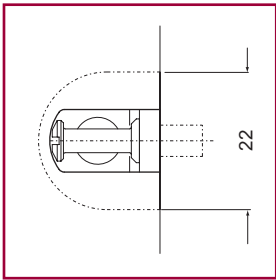

GA080M606

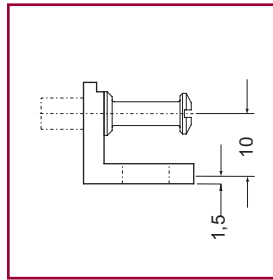
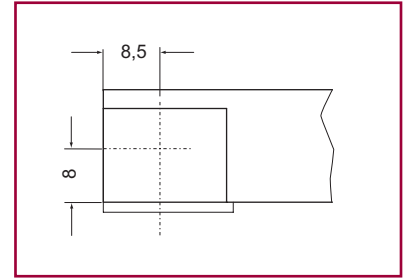

GA100M606

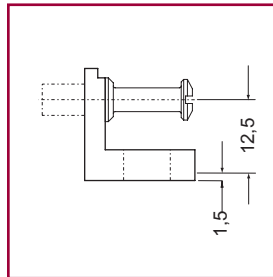
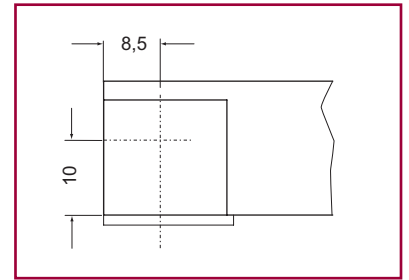

GA125M606

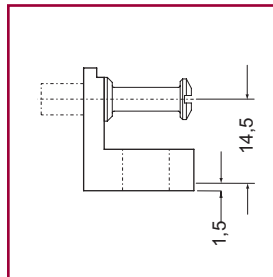
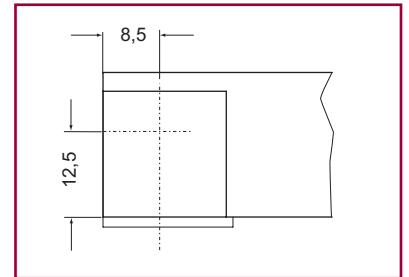

GA145M606

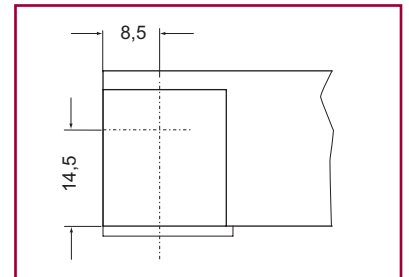

Esecuzioni disponibili

Available finishings

Oberfläche

Finitions disponibles

Colores

nichelato

nickel-pl.

vernickelt

nickelé

niquel

nero

black

schwarz

noir

negro

36

32

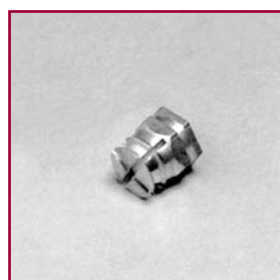

Bussola con pastiglia

Bush with pellet

Muffe mit Nylonzylinder

Insert avec pastille

Tuerca con bola

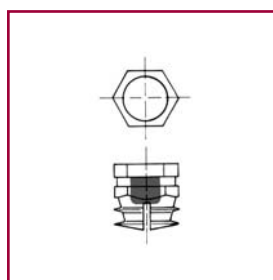

M6

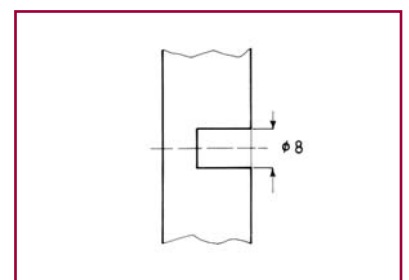

BUXP06

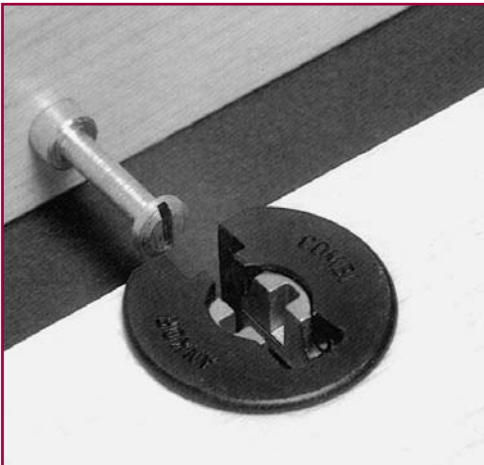
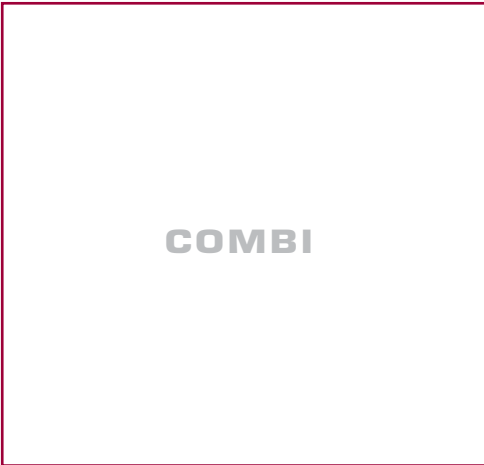
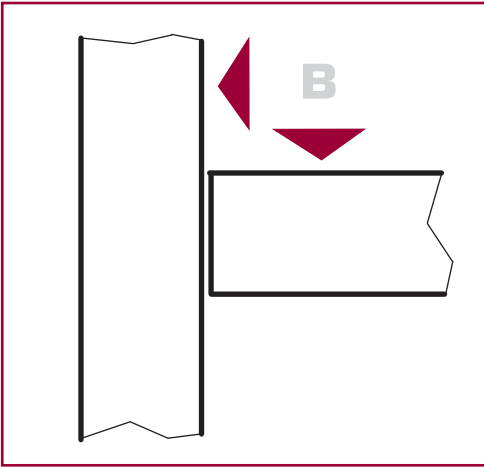
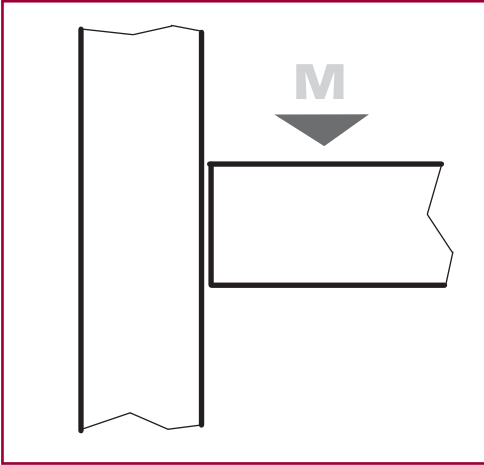

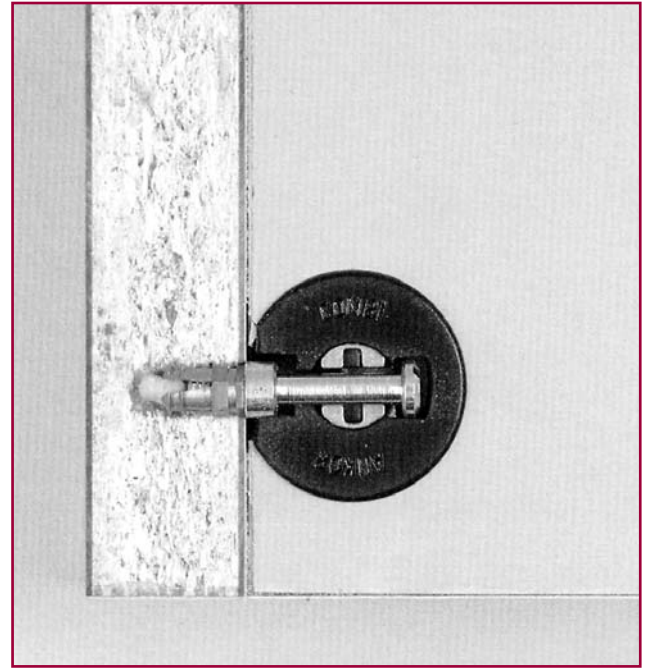
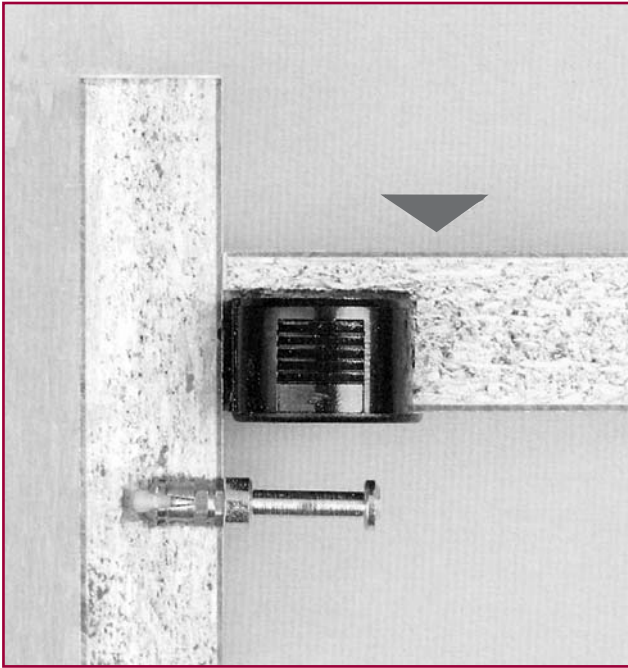

Giunti per l'assemblaggio tangente

Joint for tangent assembling

Korpusverbinder zur vertikalen Montage

Assemblage tangent

Uniones para montajes tangentes

Giunti per l'assemblaggio per accostamento

Joint for side-by-side assembling

Korpusverbinder zur horizontalen Montage

Assemblage par rapprochement

Uniones para montaje orizontal

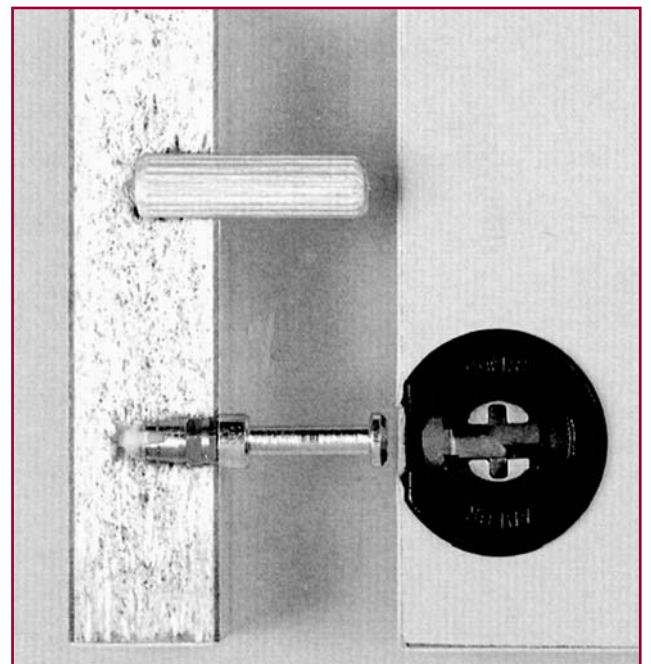
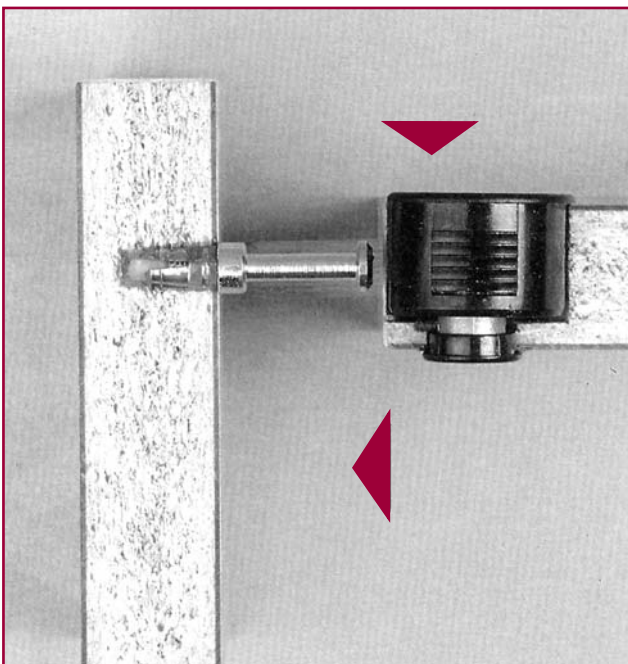



Con bordo, senza regolazione contrapposta
 With collar, without adjustment on both sides
 Gehäuse mit Rand und einseitiger Verriegelung
 Avec bord, sans réglage par le côté opposé
 Con borde, sin regulacion contraria contrapuesta

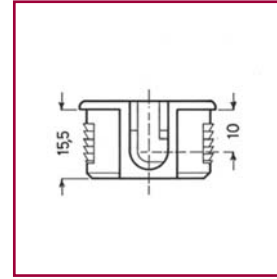
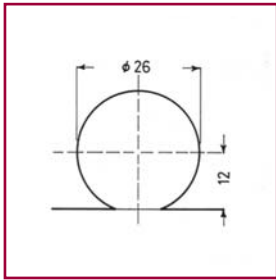

COMXB1000 COBXB1000

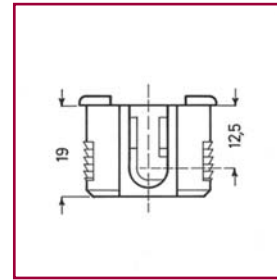
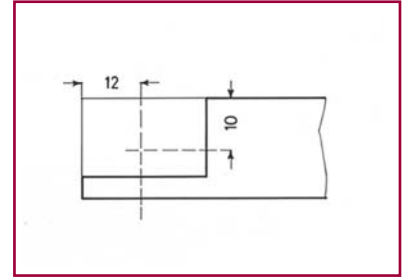

COMXB1250 COBXB1250

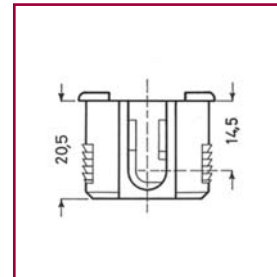
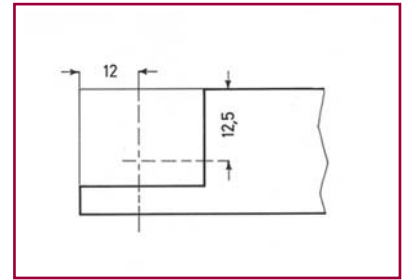

COMXB1450 COBXB1450

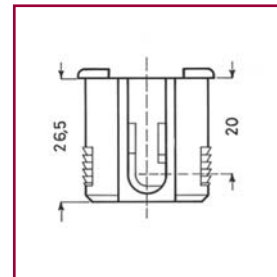
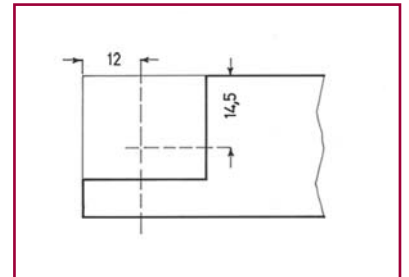

COMXB2000 COBXB2000

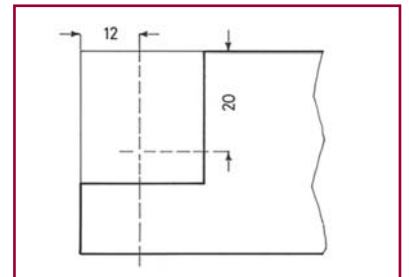

Esecuzioni disponibili
 Available finishings
 Farbe
 Finitions disponibles
 Colores

bianco	nero
white	black
weiss 01	schwarz 02
blanc	noir
blanco	negro



Chiave
 Pin
 Winkelschlüssel
 Clé
 Llave

UTCHCOMC33

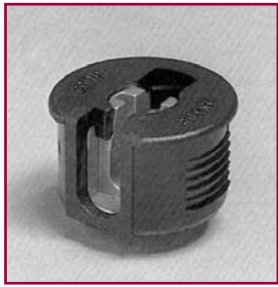

Con bordo, con regolazione contrapposta
With collar, with adjustment on both sides
Gehäuse mit Rand und beidseitiger Verriegelung
Avec bord, avec réglage par le côté opposé
Con borde, con regulacion contraria contrapuesta

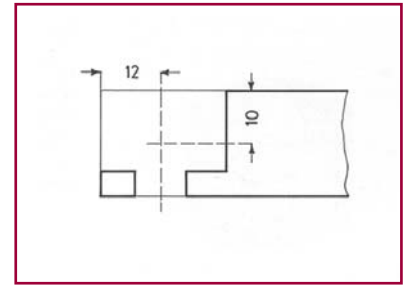
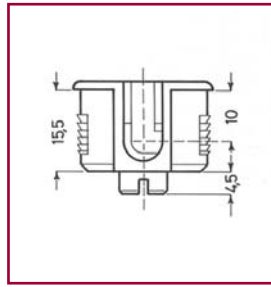

COMRB1000 COBRB1000

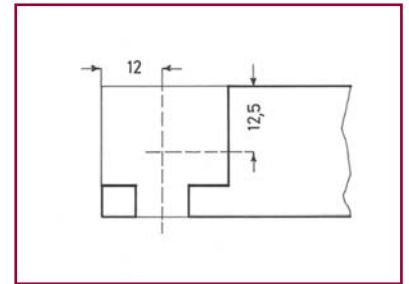
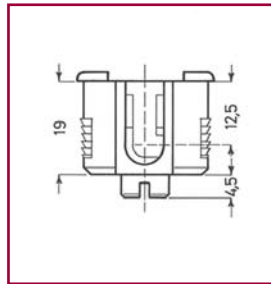

COMRB1250 COBRB1250

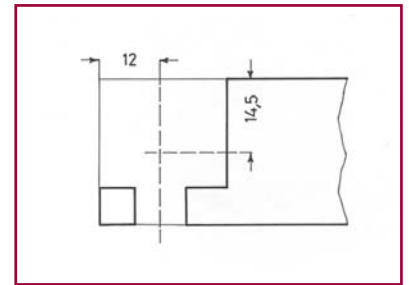
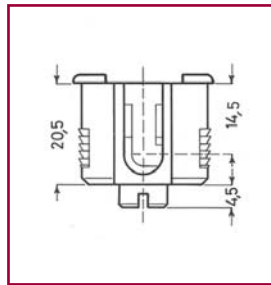
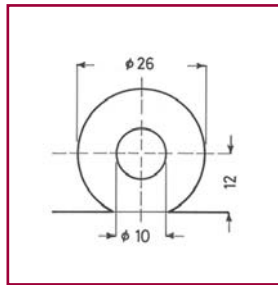

COMRB1450 COBRB1450

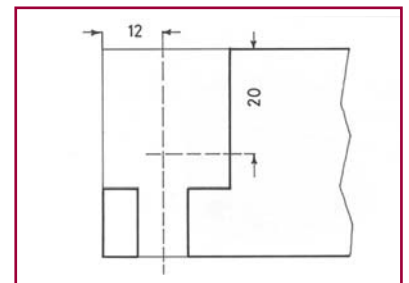
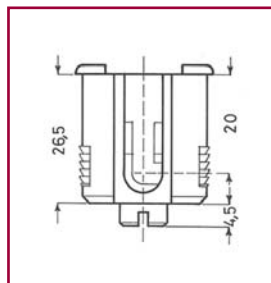

COMRB2000 COBRB2000

Esecuzioni disponibili	bianco	nero
Available finishings	white	black
Farbe	weiss 01	schwarz 02
Finitions disponibles	blanc	noir
Colores	blanco	negro

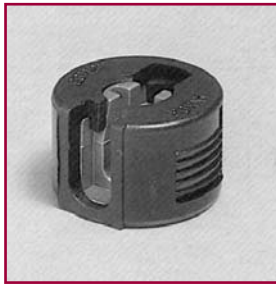

Senza bordo, senza regolazione contrapposta
 Without collar, without adjustment on both sides
 Gehäuse ohne Rand und einseitiger Verriegelung
 Sans bord, sans réglage par le côté opposé
 Sin borde, sin regulacion contraria contrapuesta

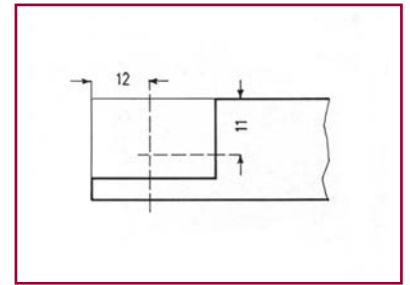
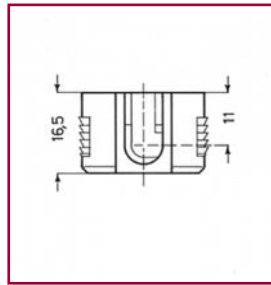

COMXX1100 COBXX1100

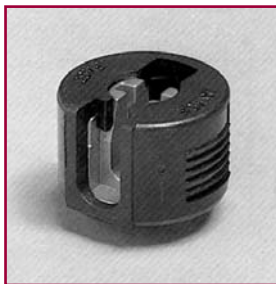
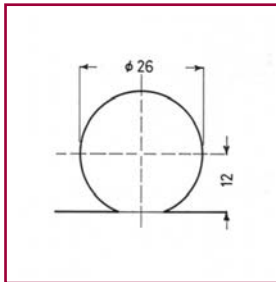

Senza bordo, senza regolazione contrapposta
 Without collar, without adjustment on both sides
 Gehäuse ohne Rand und einseitiger Verriegelung
 Sans bord, sans réglage par le côté opposé
 Sin borde, sin regulacion contraria contrapuesta

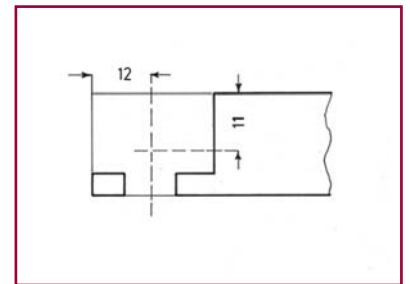
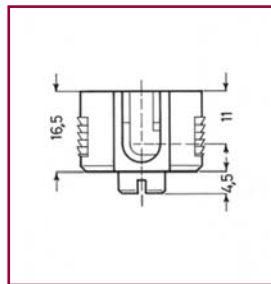

COMRX1100 COBRX1100

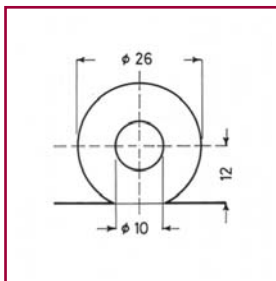

Esecuzioni disponibili	bianco	nero
Available finishings	white	black
Farbe	weiss 01	schwarz 02
Finitions disponibles	blanc	noir
Colores	blanco	negro



Perno filetto M4
Bolt with M4 thread
Gewindebolzen M4
Tige filetée M4
Pernio M4

COPMT040731



Bussola con pastiglia
Bush with pellet
Muffe mit Nylonzylinder
Insert avec pastille
Tuerca con bola

BUXP0410030



Bussola passante
Twin bush
Gewindehülse für Mittelwand
Insert passant
Tuerca pasante

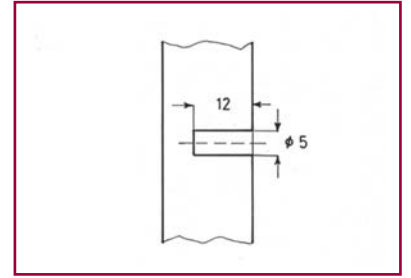
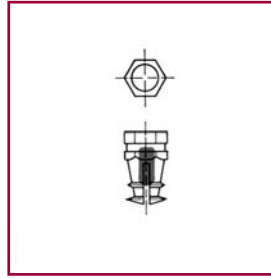
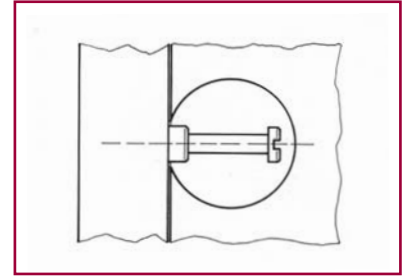
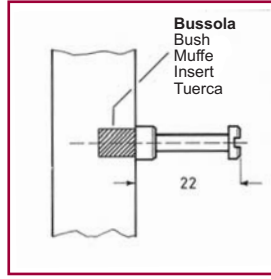

M4 x 10

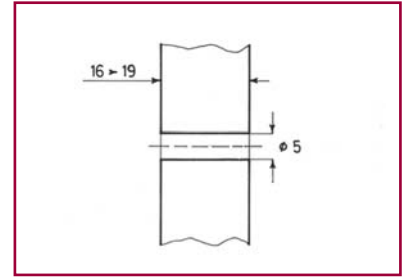
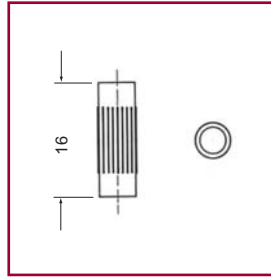

BPXXX041630 M4 x 16

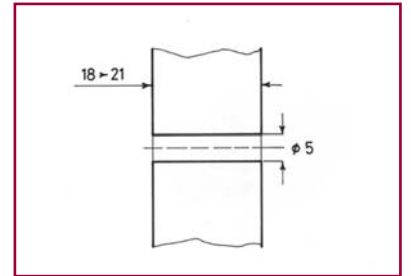
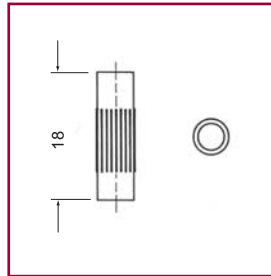

BPXXX041830 M4 x 18

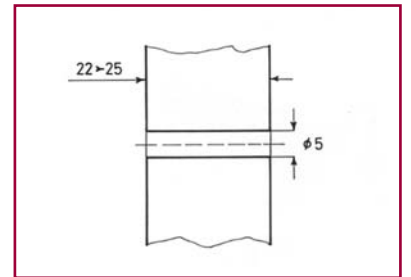
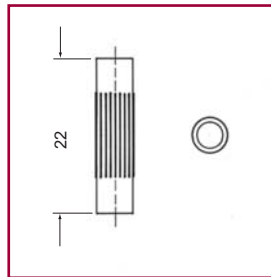

BPXXX042230 M4 x 22



Perno filetto M4 per bussola estraibile
Bolt with M4 thread for extractable bush
Gewindebolzen M4 für herausziehbare Muffe
Tige filetée M4 pour insert amovible
Pernio rosca M4 para tuerca extraible

COPMT040931

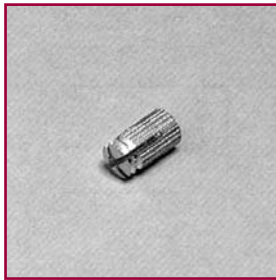

Bussola estraibile
Extractable bush
Herausziehbare Muffe
Insert amovible
Tuerca extraible

BUEX0409030



Bussola senza pastiglia
Bush without pellet
Muffe ohne Nylonzylinder
Insert sans pastille
Tuerca sin bola

BUXX0410030



Bussola passante
Twin bush
Gewindehülse für Mittelwand
Insert passant
Tuerca pasante

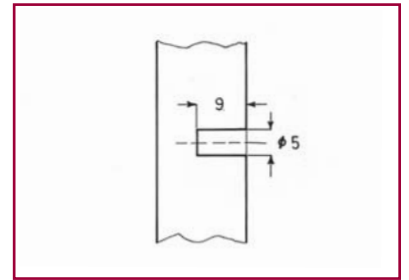
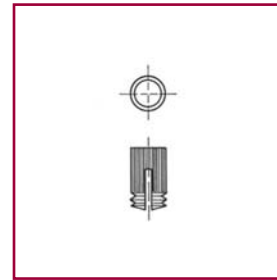
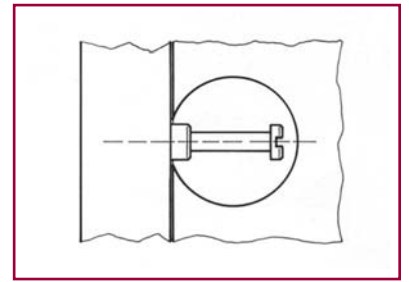
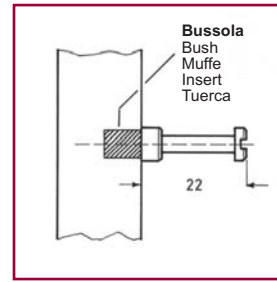

M4 x 9

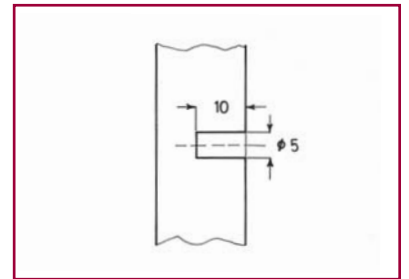
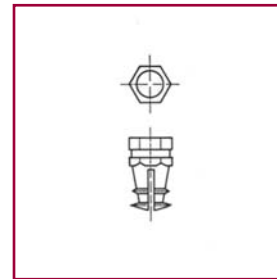

M4 x 10

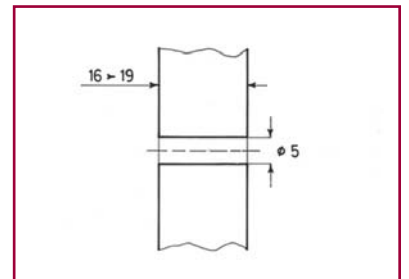
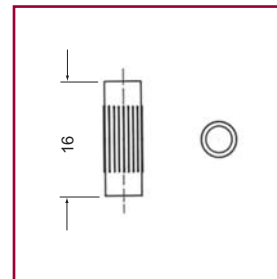

BPXXX041630 M4 x 16

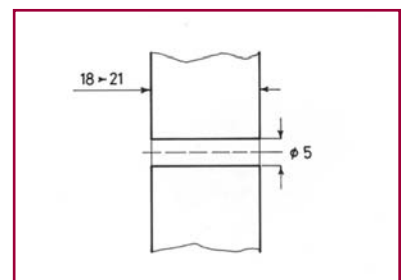
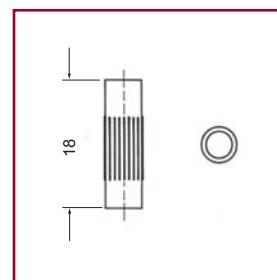

BPXXX041830 M4 x 18

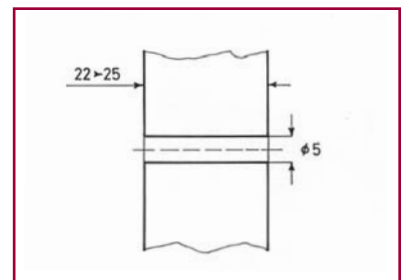
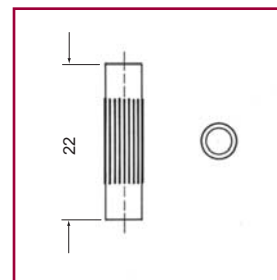

BPXXX042230 M4 x 22



Perno filetto M6x6
Bolt with M6x6 thread
Gewindebolzen M6x6
Tige filetée M6x6
Pernio M6x6

COPMT060631

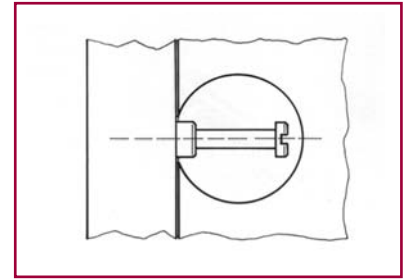
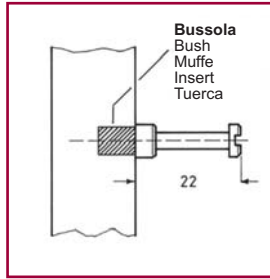

Bussola con pastiglia
Bush with pellet
Muffe mit Nylonzylinder
Insert avec pastille
Tuerca con bola

BUXP0609030

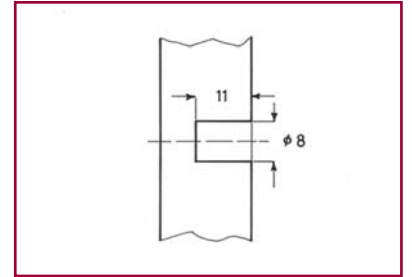
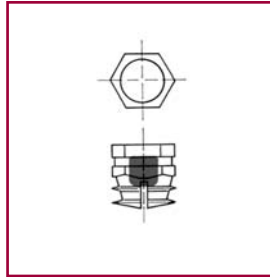

M6 x 9



Bussola con pastiglia
Bush with pellet
Muffe mit Nylonzylinder
Insert avec pastille
Tuerca con bola

BUXP0612030

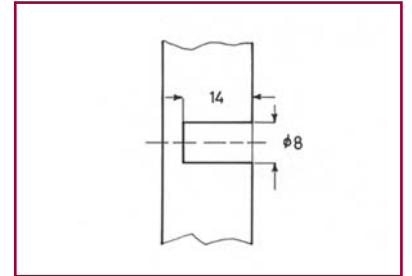
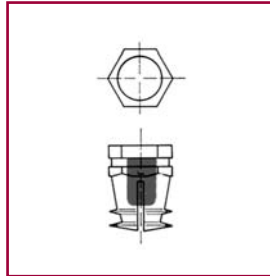

M6 x 12



Perno filetto mordente
Bolt with raised thread
Gewindebolzen zum direkten Einschrauben
Tige filetée auto-filetant
Pernio rosca madera

COPML051231

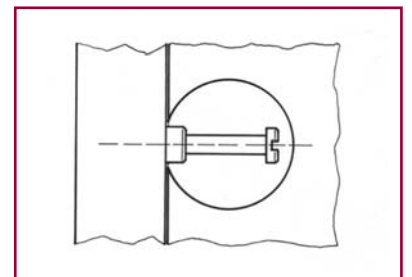
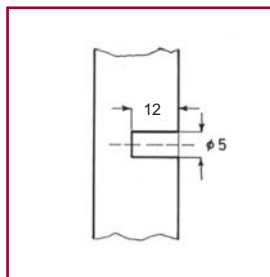

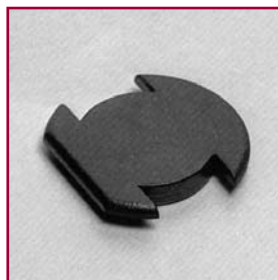

Tappo a incastro
Knock-in cap
Abdeckkappe
Bouchon à enfoncer
Tapon de encastrar

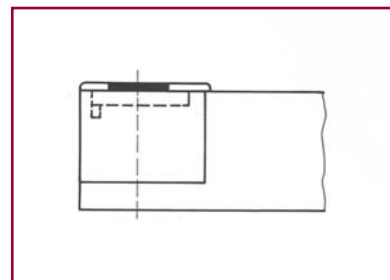
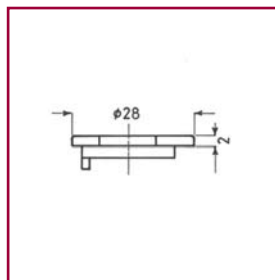

TPXCOINCA



Tappo a spina
Cap with dowel
Abdeckkappe
Bouchon avec tourillon
Tapon con pernio

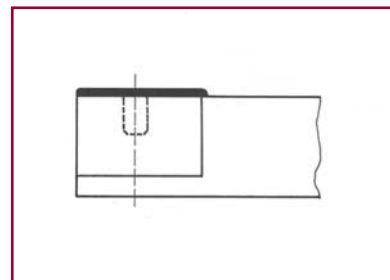
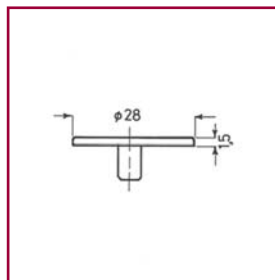

TPXCOSPIN



Tappo a collare
Cap with collar
Abdeckkappe
Bouchon avec bord
Tapon con borde

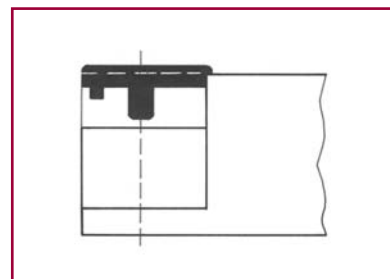
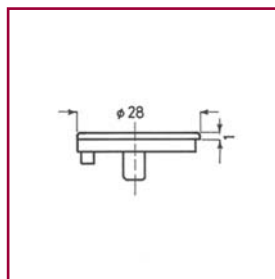

TPXCOCOLL

Esecuzioni disponibili	bianco	nero
Available finishings	white	black
Farbe	weiss 01	schwarz 02
Finitions disponibles	blanc	noir
Colores	blanco	negro

Esecuzioni disponibili	nichelato	zincato nero
Available finishings	nickel-pl.	black zinc.-pl.
Oberfläche	vernicket 36	schwarz verzinkt 32
Finitions disponibles	nickelé	zingué noir
Colores	niquel	cincado negro



Tappo chiuso per regolazione contrapposta
Closed cap for adjustment on both side
Abdeckkappe
Bouchon fermé, pour réglage par le côté opposé
Tapon cerrado para regulacion contrapuesta

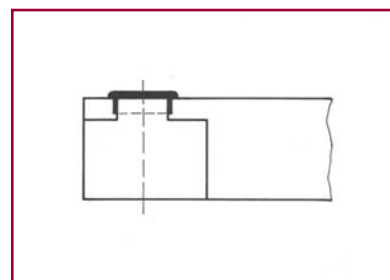
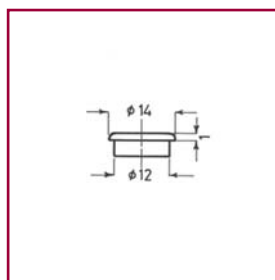

TPXZMCHIU



Tappo aperto per regolazione contrapposta
Open cap for adjustment on both sides
Abdeckkappe offen
Bouchon ouvert, pour réglage par le côté opposé
Tapon abierto para regulacion contrapuesta

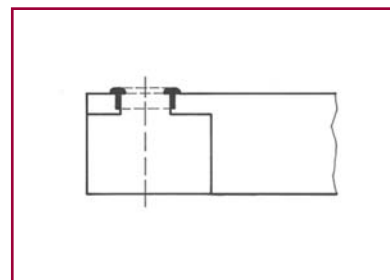
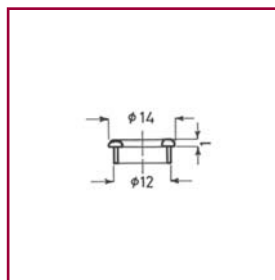

TPXZMAPER

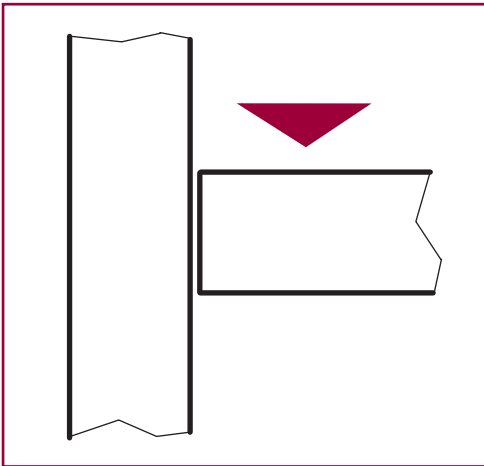

MINICOMBI

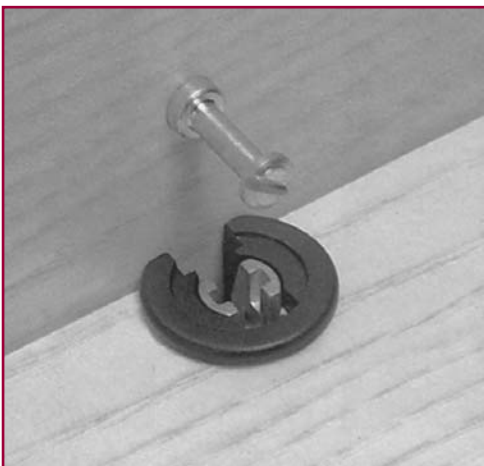

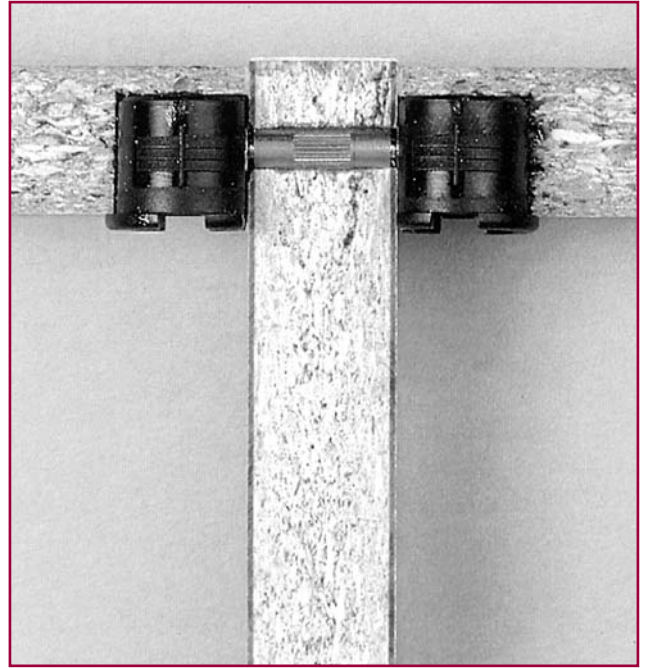
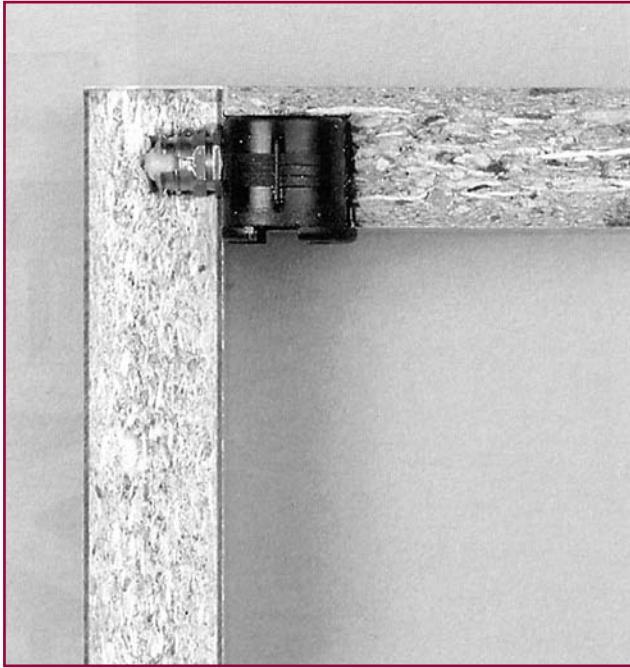

Esempi di applicazione
Assembly examples
Anwendungsbeispiele
Exemples d'utilisation
Ejemplos de aplicacion

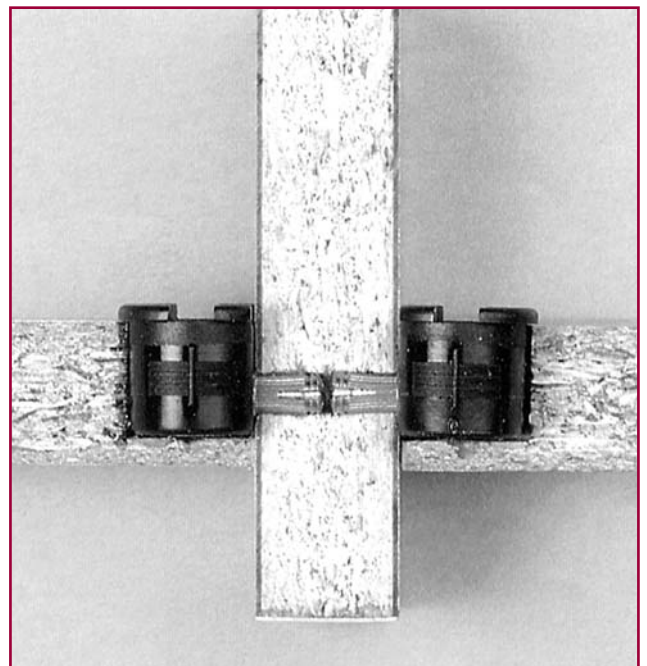
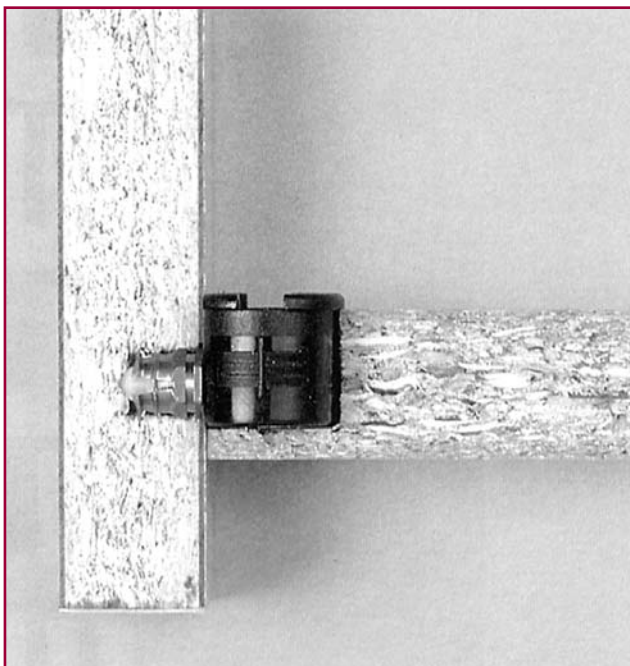

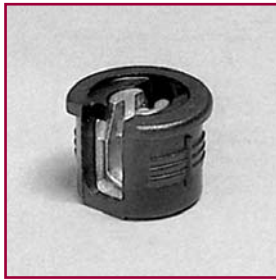

Con bordo
With collar
Gehäuse mit Rand
Avec bord
Con borde

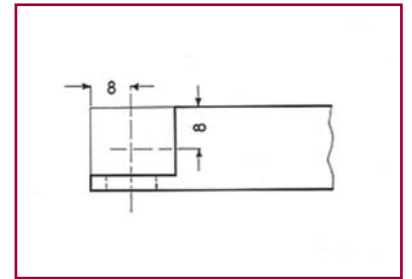
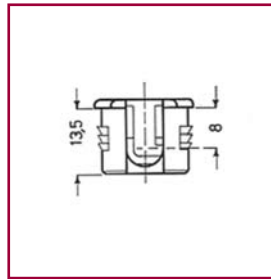

MCXRB0800

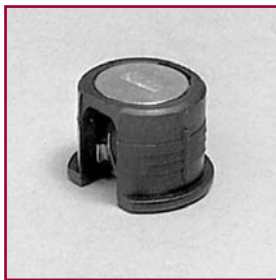

Con possibile regolazione contrapposta
With possible adjustment on both side
Mit beidseitiger Verriegelung
Avec possibilité de réglage par le côté opposé
Con posibilidad de regulacion contraria contrapuesta

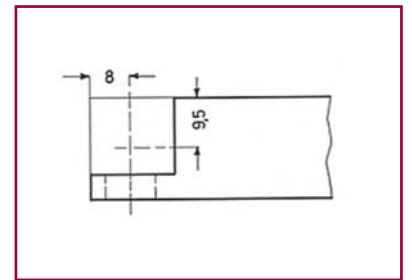
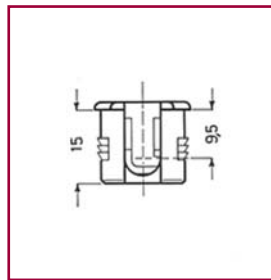

MCXRB0950

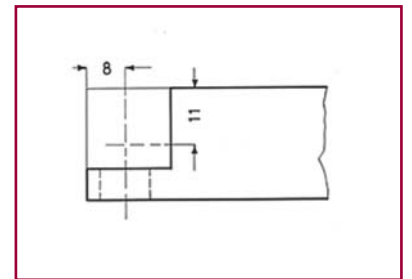
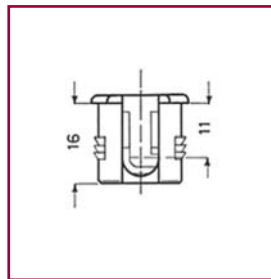
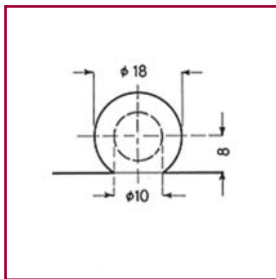

MCXRB1100

Esecuzioni disponibili
Available finishings
Farbe
Finitions disponibles
Colores

bianco white weiss	nero black schwarz
01	02
blanc	noir
blanco	negro

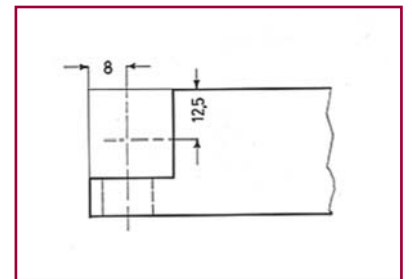
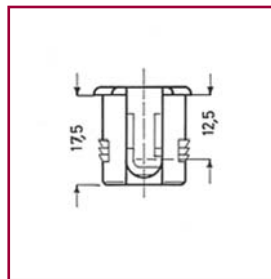

MCXRB1250



Tappo
Cap
Kappe
Bouchon
Tapon

No per art.
Not for art.
Nicht für Art.
Pas pour art.
No para art.

MCXRB0800

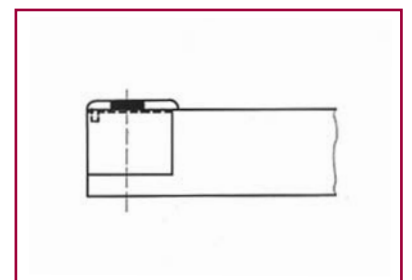
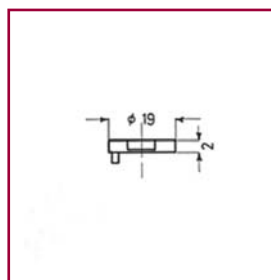

MCTPLINCA



Chiave
Pin
Winkelschlüssel
Clé
Llave

UTXCHCOMC33



Perno filetto M4 per bussola estraibile

Bolt with M4 thread for extractable bush

Gewindebolzen M4 für herausziehbare Muffe

Tige filetée M4 pour insert amovible

Pernio rosca M4 para tuerca extraible

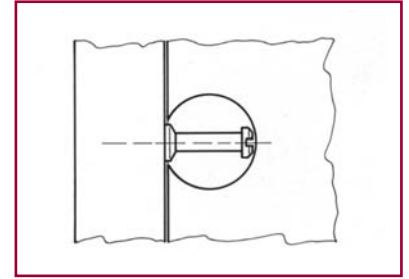
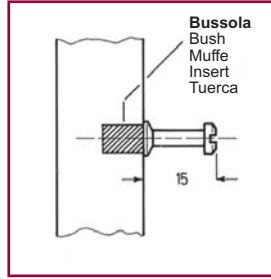

MCPMT040931



Bussola estraibile

Extractable bush

Herausziehbare Muffe

Insert amovible

Tuerca extraible

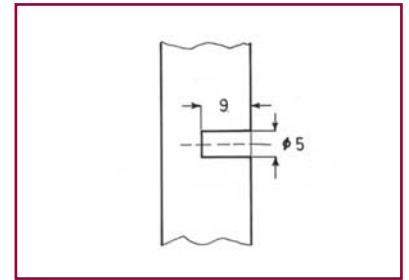
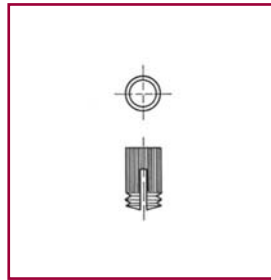

BUEX0409030



Bussola senza pastiglia

Bush without pellet

Muffe ohne Nylonzylinder

Insert sans pastille

Tuerca sin bola

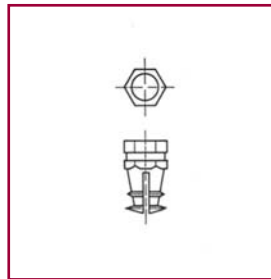

M4 x 9

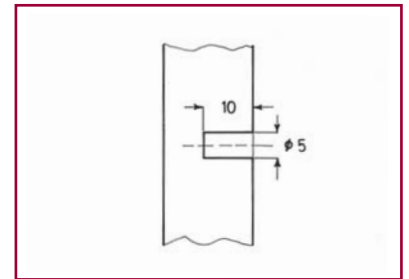

BUXX0410030



Bussola passante

Twin bush

Gewindehülse für Mittelwand

Insert passant

Tuerca pasante

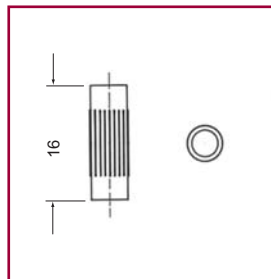

M4 x 10

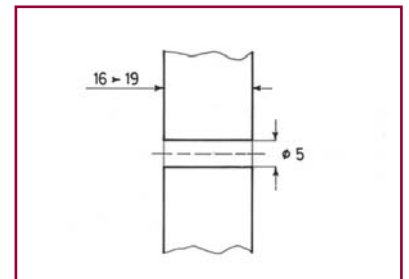

BPXXX041630 M4 x 16

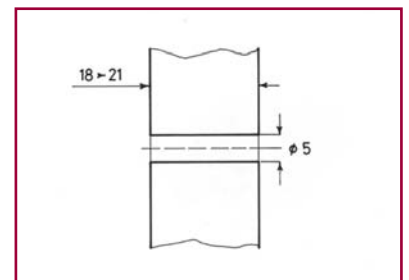
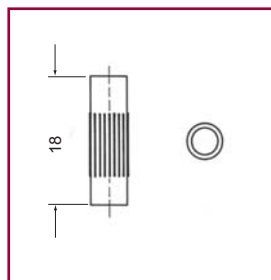

BPXXX041830 M4 x 18

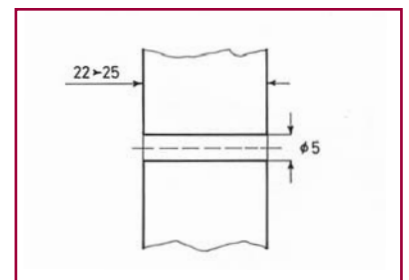
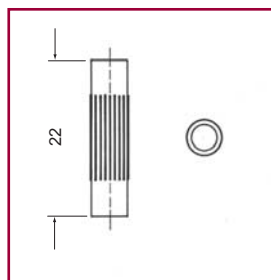

BPXXX042230 M4 x 22



Perno filetto M4
Bolt with M4 thread
Gewindebolzen M4
Tige filetée M4
Pernio M4

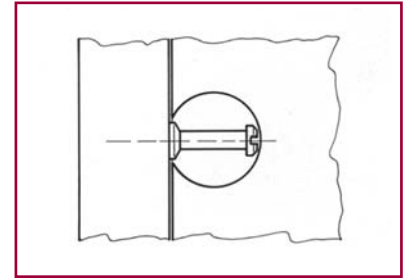
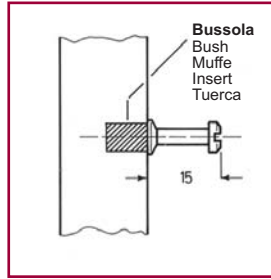

MCPMT040731



Bussola con pastiglia
Bush with pellet
Muffe mit Nylonzylinder
Insert avec pastille
Tuerca con bola

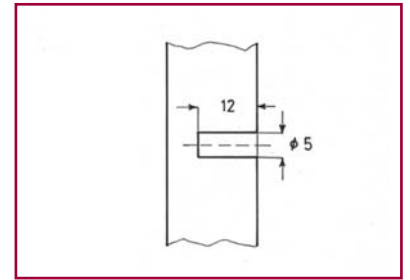
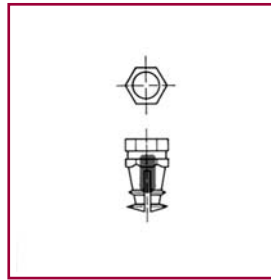

BUXP0410030

M4 x 10



Bussola passante
Twin bush
Gewindehülse für Mittelwand
Insert passant
Tuerca pasante

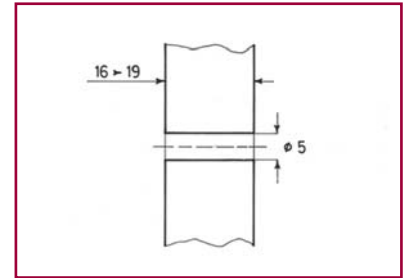
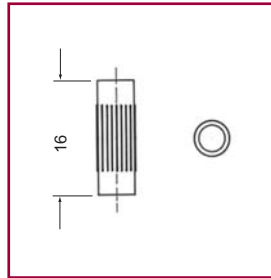

BPXXX041630 M4 x 16

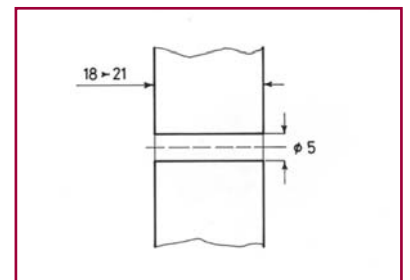
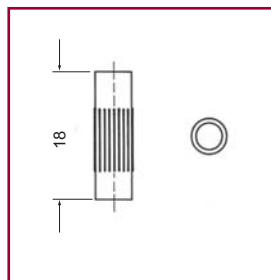

BPXXX041830 M4 x 18

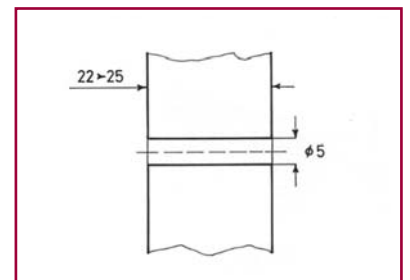
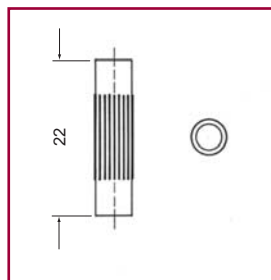

BPXXX042230 M4 x 22

L'azienda si riserva di apportare modifiche estetiche o funzionali ai prodotti senza preavviso. Aesthetics and functional changes can be made without prior notice.

GIUNTI VERTICALI

**VERTICAL JOINTS
VERTIKALVERBINDER
JONCTIONS VERTICALES
UNIONES VERTICALES**

EFFEGI BREVETTI s.r.l.

20090 Segrate (MI) - tel. +39 02 26921838 - fax +39 02 26921737 - www.eggibrevetti.it - e-mail info@eggibrevetti.it