

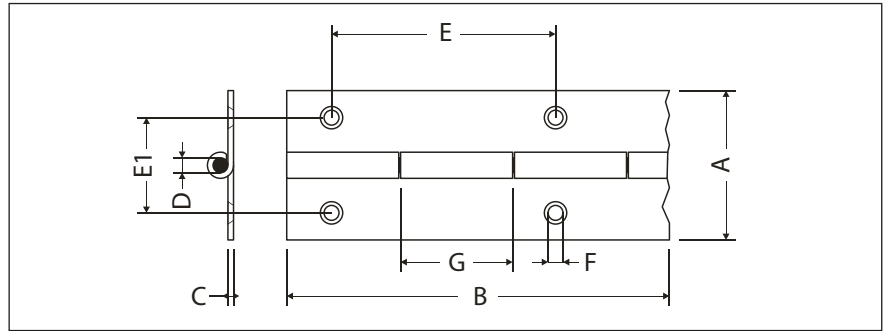

Art. 230001.

Piano hinge, holes, countersank, length acc. to customer instruction

Material: Stainless Steel 1.4301
Finish: natural



A	B	C	D	E	E1	F	G
16 - 60	1.980	0,7 - 3	1,5 - 9	60	9 - 29	2 - 6, 5	10 - 30



Art. 230500.

Hinge, Stainless Steel 1.4301

Finish: natural

A	B	C	D	G
30	40	1,5	4	5
40	40	1,5	4	5
40	60	1,5	4	5
40	80	1,5	4	5



Art. 230501.

Hinge, Stainless Steel 1.4301

Finish: natural

A	B	C	D	G
70	40	1,5	4	5



Art. 230502.

Hinge, Stainless Steel 1.4301

Finish: natural

A	B	C	D	G
80	20	1,5	4	5
90	30	1,5	4	5
100	40	1,5	4	5



Art. 230503.

Hinge, Stainless Steel 1.4301

Finish: natural

A	B	C	D	G
75	20	1,5	4	5
85	30	1,5	4	5
100	40	1,5	4	5

Other sizes, materials and versions can be supplied on demand.



Table hinge, Stainless Steel 1.4301

Finsh: natural

A	B	C	D	G
81,5	30	1,5	4	10

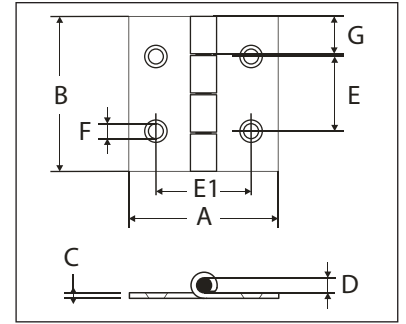

Hinge, Stainless Steel 1.4301

Finsh: natural

A	B	C	D	G
185	40	1,5	4	10



Hinge, Stainless Steel 1.4301

Finsh: natural

A	B	C	D	G
130	40	1,5	4	10



Hinge, Stainless Steel 1.4301

Finsh: natural

A	B	C	D	G
90	60	3	8	10



Hinge, Stainless Steel 1.4301

Finsh: natural

A	B	C	D	G
95	60	2	6	10

Other sizes, materials and versions can be supplied on demand.